

THIS PLAN IS A PRELIMINARY DESIGN. IT IS NOT TO BE USED FOR CONSTRUCTION WITHOUT THE WRITTEN APPROVAL OF BJA. THE DESIGNER DOES NOT WARRANT THE ACCURACY OF THE INFORMATION PROVIDED FOR THIS PLAN. THE DESIGNER SHALL NOT BE RESPONSIBLE FOR ANY DAMAGES, INCLUDING REASONABLE ATTORNEY'S FEES, ARISING FROM THE USE OF THIS PLAN. THE USER OF THIS PLAN SHALL BE RESPONSIBLE FOR OBTAINING ALL NECESSARY PERMITS AND FOR THE ULTIMATE RIGHT-OF-WAY. THE DESIGNER SHALL NOT BE RESPONSIBLE FOR ANY DAMAGES, INCLUDING REASONABLE ATTORNEY'S FEES, ARISING FROM THE USE OF THIS PLAN. THE USER OF THIS PLAN SHALL BE RESPONSIBLE FOR OBTAINING ALL NECESSARY PERMITS AND FOR THE ULTIMATE RIGHT-OF-WAY.

REVISIONS :	
DATE	DESCRIPTION

PROPOSED SITE PLAN	
SNIPES TRACT ATHLETIC FIELDS	
LOWER MAKEFIELD TOWNSHIP BUCKS COUNTY, PENNSYLVANIA	
LOWER MAKEFIELD TOWNSHIP 1100 EDGEWOOD ROAD YARDELY, PA 19067	

PROJECT	DATE

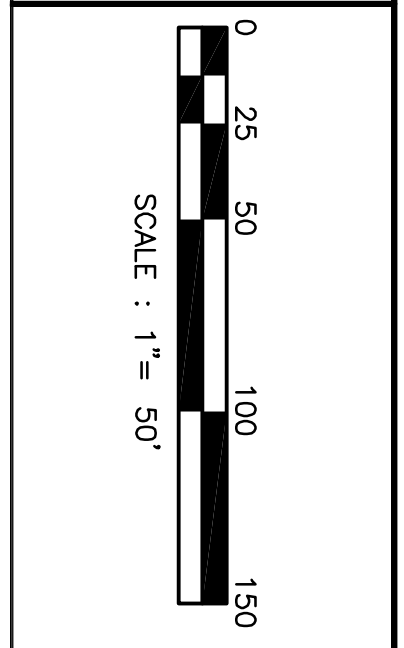

DATE	BY	SCALE
16/7/05/4		

Boucher & James, Inc.	
1211 S. SOUTH ST.	
DOYLESTOWN, PA 19340	
CORPORATE HEADQUARTERS: 148 FERRY RD, BUILDING 200, DOYLESTOWN, PA 18011	
VOICE: (215) 345-3400	FAX: (215) 345-3401
www.bja.com	

SHEET	DATE
1 OF 1	MAY 19, 2017

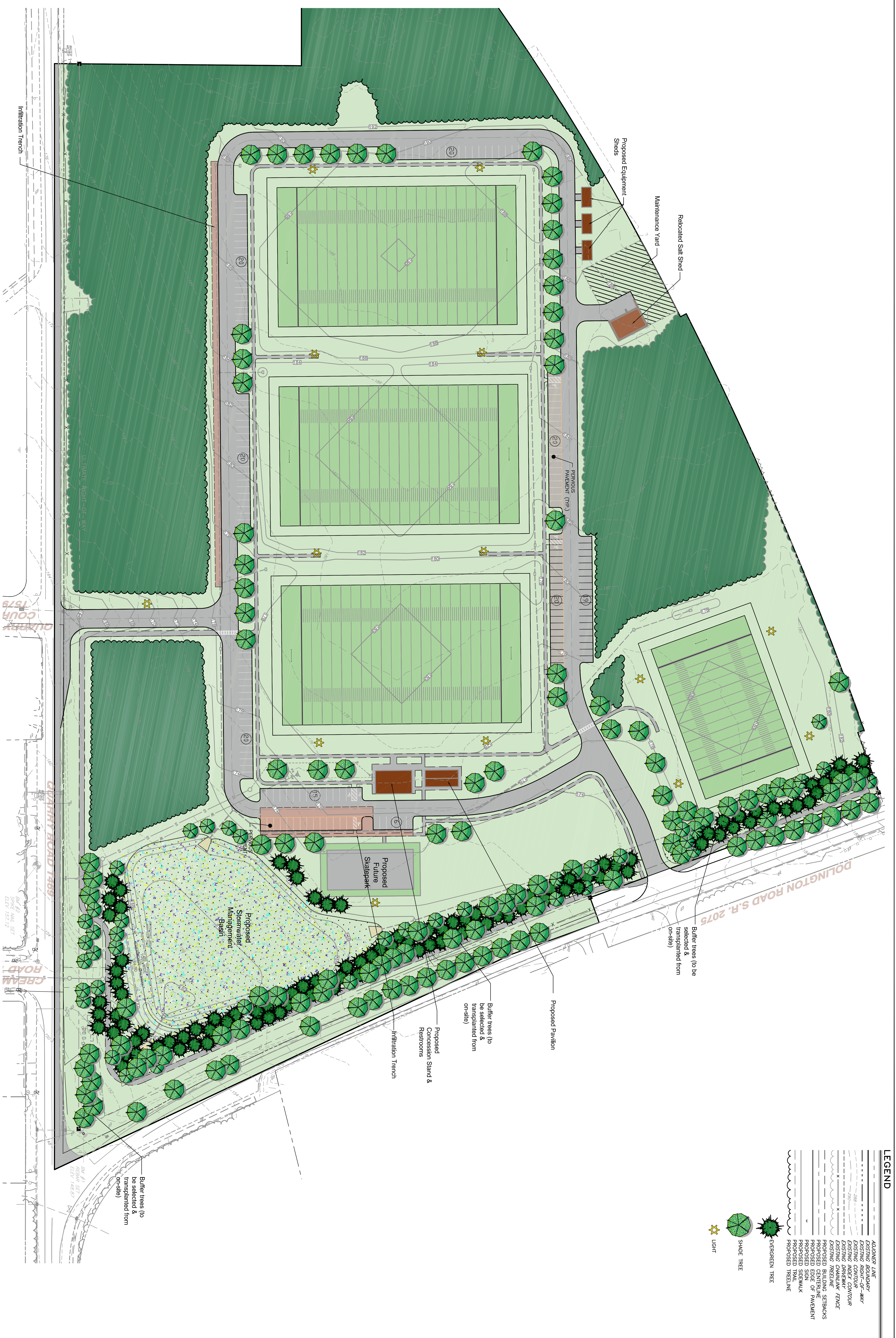

LEGEND

[Line style]	ADJACENT BOUNDARY
[Line style]	EXISTING BOUNDARY
[Line style]	EXISTING RIGHT-OF-WAY
[Line style]	EXISTING CONTOUR
[Line style]	EXISTING AREA CONTOUR
[Line style]	EXISTING CHAINLINK FENCE
[Line style]	EXISTING TREELINE
[Line style]	PROPOSED BUILDING SETBACKS
[Line style]	PROPOSED CENTERLINE
[Line style]	PROPOSED SIDE OF PAVEMENT
[Line style]	PROPOSED SITEMARK
[Line style]	PROPOSED TRAIL
[Line style]	PROPOSED TREE LINE
[Symbol]	EVERGREEN TREE
[Symbol]	SHADE TREE
[Symbol]	LIGHT